

2
3
4
5
6
7
8
9
10
11
12
13
14
15
16
17
18
19
20
21
22
23
24
25
26
27
28

IN THE UNITED STATES DISTRICT COURT
FOR THE DISTRICT OF NEVADA

UNITED STATES OF AMERICA,)	
)	
Plaintiff,)	In Equity No. C-125-ECR
)	Subfile No. C-125-B
WALKER RIVER PAIUTE TRIBE,)	
)	NOTICE OF CHANGE OF
Plaintiff-Intervenor,)	OWNERSHIP OF WATER RIGHT
)	
v.)	
)	
WALKER RIVER IRRIGATION DISTRICT,)	
a corporation, et al.,)	
)	
Defendants.)	
)	

The undersigned counter-defendant in the above action hereby notifies the Court and the United States that the undersigned (or the entity on whose behalf the undersigned is acting) has sold or otherwise conveyed ownership of all or a portion of a water right within one or more of the categories set forth in Paragraph 3 of the Case Management Order and provides the following information:

1. The name and address of the party or parties who sold or otherwise conveyed ownership:

Andrew McB. Sinclair, Trustee under the Andrew McB.
Sinclair Trust
Name(s)
834 West Bridge St.
Street or P.O. Box

2
3
4
5
6
7
8
9
10
11
12
13
14
15
16
17
18
19
20
21
22
23
24
25
26
27
28

Yerington NV 89449

Town or City State ZipCode

2. The name and address of each person or entity who acquired ownership

Daniel Villalobos

Name(s)

1172 Big-Jake Crt.

Street or P.O. Box

Gardnerville

NV

89460

Town or City

State

ZipCode

3. Attached to or included with this notice is a copy of the (check appropriate box(es)):

- Deed
- Court Order
- Other Document.

by which the change in ownership was accomplished.

4. The undersigned acknowledges that any person or entity who files a Notice of Change of Ownership of Water Right using this form is ultimately responsible for the accuracy of this filing. Consequently, the undersigned acknowledges that any person or entity who files

* This notice shall be sent to the following two persons:

Linda Lea Sharer, Chief Deputy Clerk
United States District Court for the District of Nevada
400 South Virginia Street, Suite 301
Reno, NV 89501

And

Susan L. Schneider
United States Department of Justice
P.O. Box 756
Littleton, CO 80160

such a notice, but retains such water rights, shall nevertheless, be bound by the results of this

2
3
4
5
6
7
8
9
10
11
12
13
14
15
16
17
18
19
20
21
22
23
24
25
26
27
28

litigation.

Executed this 30 day of AUGUST ²⁰¹⁰ ~~200~~

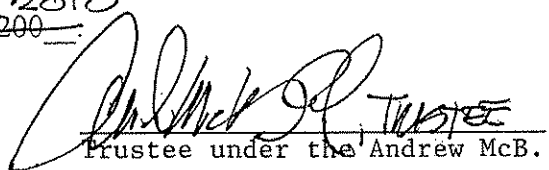
Trustee under the Andrew McB.
Sinclair Trust

[signature of counter-defendant]

Andrew McB. Sinclair, Trustee
under the Andrew McB. Sinclair
Trust

[name of counter-defendant]

[signature, if applicable, of person acting on
behalf of counter-defendant]

[name, if applicable, of person acting on
behalf of counter-defendant]

PO. BOX 155, OVERTON, NV
[address] 89640

(702) 357-6800
[telephone number]

DOC# 460526

06/16/2010 04:30PM

Official Record

Requested By
FIRST AMERICAN TITLE MIND

Lyon County - NV

Mary C. Milligan - Recorder

Page: 1 of 3 Fee: \$16.00
Recorded By AT RPTT: \$487.50

A.P.N.: 012-031-06
File No: 143-2396473 (Rt)
R.P.T.T.: \$487.50



0460526

When Recorded Mail To: Mail Tax Statements To:
Daniel Villalobos
834 West Bridge Street
Yerington, NV 89447

GRANT, BARGAIN and SALE DEED

FOR A VALUABLE CONSIDERATION, receipt of which is hereby acknowledged,

Andrew McB. Sinclair, Trustee or his successor in trust under the Andrew McB. Sinclair Trust dated 3/10/1989

do(es) hereby GRANT, BARGAIN and SELL to

Daniel Villalobos, a married man as his sole and separate property

the real property situate in the County of Lyon, State of Nevada, described as follows:

PARCEL 1:

A PARCEL OF LAND IN THE NORTHWEST 1/4 OF SECTION 22 AND NORTHEAST 1/4 OF SECTION 21, TOWNSHIP 13 NORTH, RANGE 25 EAST, MOUNT DIABLO MERIDIAN, BOUNDED AND DESCRIBED AS FOLLOWS:

COMMENCING AT THE NW CORNER OF SAID SECTION 22, MARKED BY A STANDARD BUREAU OF LAND MANAGEMENT PIPE AND BRASS CAP, FROM WHICH THE NORTH 1/4 CORNER OF SAID SECTION 22 BEARS SOUTH 89°25'24" EAST; THENCE SOUTH 00°43'43" WEST, 1313.83 FEET TO THE NW CORNER OF THE SOUTH 1/2 OF THE NW 1/4 OF SAID SECTION 22, MARKED BY A 5/8" REBAR AND CAP MARKED PLS 10596, SET PER MAP FILE NO. 192614, LYON COUNTY OFFICIAL RECORDS, YERINGTON, NEVADA; THENCE SOUTH 00°44'56" WEST, 582.68 FEET TO A POINT ON THE WESTERLY LINE OF SAID SECTION 22 MARKED BY A 5/8" REBAR WITH CAP MARKED PLS 6200, PER MAP FILE NO. 172217, LYON COUNTY OFFICIAL RECORDS, THE POINT OF BEGINNING; THENCE AROUND THE PARCEL AS FOLLOWS:



SOUTH 89°41'09" WEST, 17.46 FEET; THENCE SOUTH 08°29'55" WEST, 125.44 FEET; THENCE SOUTH 00°32'08" EAST, 121.26 FEET; THENCE SOUTH 79°27'02" EAST, 32.12 FEET TO A POINT ON THE WESTERLY LINE OF SAID SECTION 22; THENCE ALONG SAID WESTERLY LINE, SOUTH 00°44'57" WEST, 433.92 FEET; THENCE SOUTH 89°26'34" EAST, 354.64 FEET; THENCE NORTH 10°49'50" EAST, 86.64 FEET; THENCE NORTH 13°55'52" WEST, 118.08 FEET; THENCE NORTH 41°09'51" WEST, 265.61 FEET; THENCE NORTH 07°29'00" WEST 189.66 FEET; THENCE NORTH 05°28'41" EAST, 102.18 FEET; THENCE SOUTH 89°41'09" WEST, 143.74 FEET TO THE POINT OF BEGINNING.

SAID PARCEL AS FURTHER DELINEATED ON LYON COUNTY RECORD OF SURVEY MAP, RECORDED ON MAY 13, 2004 AS DOCUMENT NO. 320472.

PARCEL 2:

A 30 FOOT WIDE ROAD EASEMENT AS DESCRIBED IN DOCUMENT RECORDED NOVEMBER 22, 1927, IN BOOK Y, PAGE 311 AND IN DOCUMENT RECORDED JUNE 25, 1951 IN BOOK 36, PAGE 524, OF OFFICIAL RECORDS.

PARCEL 3:

A PERMANENT AND EXCLUSIVE ACCESS EASEMENT AS SET FORTH IN EXCLUSIVE ACCESS EASEMENT RECORDED AUGUST 3, 2007 AS INSTRUMENT NO. 411567 OF OFFICIAL RECORDS.

NOTE : THE ABOVE METES AND BOUNDS DESCRIPTION APPEARED PREVIOUSLY IN THAT CERTAIN DOCUMENT RECORDED APRIL 12, 2007, AS INSTRUMENT NO. 404249.

Subject to

TOGETHER with all tenements, hereditaments and appurtenances, including easements and water rights, if any, thereto belonging or appertaining, and any reversions, remainders, rents, issues or profits thereof.

Date: 05/25/2010

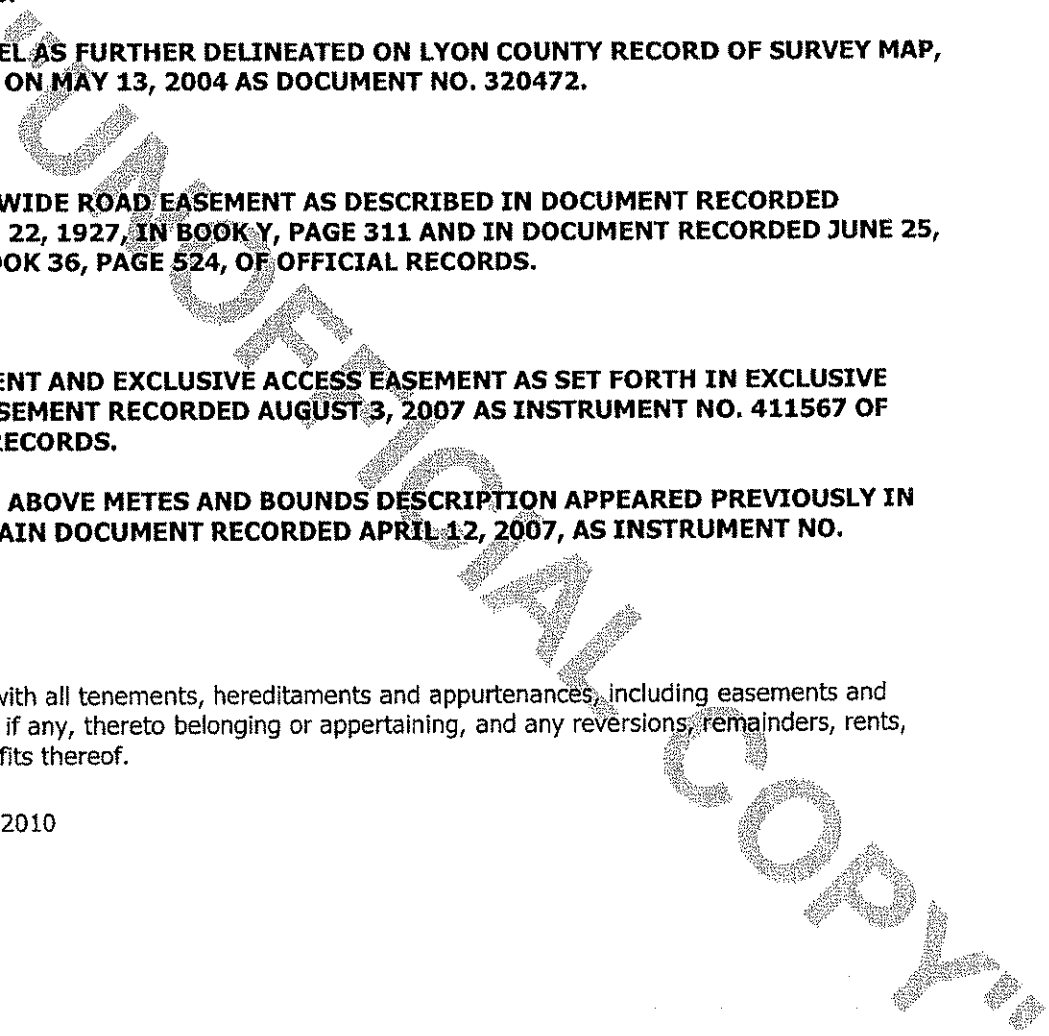

Andrew McB. Sinclair, Trustee or his
successor in trust under the Andrew McB.
Sinclair Trust dated 3/10/1989

Andrew McB. Sinclair TRUSTEE
Andrew McB. Sinclair, Trustee

STATE OF **NEVADA** : ss.
COUNTY OF **DOUGLAS**

This instrument was acknowledged before me on 6/11/10 by
**Andrew McB. Sinclair, Trustee or his successor in trust under the Andrew McB.
Sinclair Trust dated 3/10/1989.**

Rishele L Thompson
Notary Public
(My commission expires: 4/10/11)

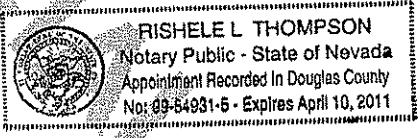

This Notary Acknowledgement is attached to that certain Grant, Bargain Sale Deed dated **May 25, 2010** under Escrow No. **143-2396473**.

UNNOTED COPY

DOC# 460527

06/16/2010

04:30PM

Official Record

Requested By
FIRST AMERICAN TITLE MIND

Lyon County - NV

Mary C. Milligan - Recorder

Page: 1 of 3

Fee: \$41.00

Recorded By AT

RPTT: \$0.00

A.P.N.: 012-031-06
File No: 143-2396473 (Rt)
R.P.T.T.: 



0460527

When Recorded Mail To: Mail Tax Statements To:
Daniel Villalobos
1172 Big Jake Court
Gardnerville, NV 89460

GRANT, BARGAIN and SALE DEED

FOR A VALUABLE CONSIDERATION, receipt of which is hereby acknowledged,

Jennifer Clark Kirby wife of the Grantee

do(es) hereby GRANT, BARGAIN and SELL to

Daniel Villalobos, a married man as his sole and separate property

the real property situate in the County of Lyon, State of Nevada, described as follows:

PARCEL 1:

A PARCEL OF LAND IN THE NORTHWEST 1/4 OF SECTION 22 AND NORTHEAST 1/4 OF SECTION 21, TOWNSHIP 13 NORTH, RANGE 25 EAST, MOUNT DIABLO MERIDIAN, BOUNDED AND DESCRIBED AS FOLLOWS:

COMMENCING AT THE NW CORNER OF SAID SECTION 22, MARKED BY A STANDARD BUREAU OF LAND MANAGEMENT PIPE AND BRASS CAP, FROM WHICH THE NORTH 1/4 CORNER OF SAID SECTION 22 BEARS SOUTH 89°25'24" EAST; THENCE SOUTH 00°43'43" WEST, 1313.83 FEET TO THE NW CORNER OF THE SOUTH 1/2 OF THE NW 1/4 OF SAID SECTION 22, MARKED BY A 5/8" REBAR AND CAP MARKED PLS 10596, SET PER MAP FILE NO. 192614, LYON COUNTY OFFICIAL RECORDS, YERINGTON, NEVADA; THENCE SOUTH 00°44'56" WEST, 582.68 FEET TO A POINT ON THE WESTERLY LINE OF SAID SECTION 22 MARKED BY A 5/8" REBAR WITH CAP MARKED PLS 6200, PER MAP FILE NO. 172217, LYON COUNTY OFFICIAL RECORDS, THE POINT OF BEGINNING; THENCE AROUND THE PARCEL AS FOLLOWS:

SOUTH 89°41'09" WEST, 17.46 FEET; THENCE SOUTH 08°29'55" WEST, 125.44 FEET; THENCE SOUTH 00°32'08" EAST, 121.26 FEET; THENCE SOUTH 79°27'02" EAST, 32.12 FEET TO A POINT ON THE WESTERLY LINE OF SAID SECTION 22; THENCE ALONG SAID WESTERLY LINE, SOUTH 00°44'57" WEST, 433.92 FEET; THENCE SOUTH 89°26'34" EAST, 354.64 FEET; THENCE NORTH 10°49'50" EAST, 86.64 FEET; THENCE NORTH 13°55'52" WEST, 118.08 FEET; THENCE NORTH 41°09'51" WEST, 265.61 FEET; THENCE NORTH 07°29'00" WEST 189.66 FEET; THENCE NORTH 05°28'41" EAST, 102.18 FEET; THENCE SOUTH 89°41'09" WEST, 143.74 FEET TO THE POINT OF BEGINNING.

SAID PARCEL AS FURTHER DELINEATED ON LYON COUNTY RECORD OF SURVEY MAP, RECORDED ON MAY 13, 2004 AS DOCUMENT NO. 320472.



460527

06/16/2010
2 of 3

PARCEL 2:

A 30 FOOT WIDE ROAD EASEMENT AS DESCRIBED IN DOCUMENT RECORDED NOVEMBER 22, 1927, IN BOOK Y, PAGE 311 AND IN DOCUMENT RECORDED JUNE 25, 1951 IN BOOK 36, PAGE 524, OF OFFICIAL RECORDS.

PARCEL 3:

A PERMANENT AND EXCLUSIVE ACCESS EASEMENT AS SET FORTH IN EXCLUSIVE ACCESS EASEMENT RECORDED AUGUST 3, 2007 AS INSTRUMENT NO. 411567 OF OFFICIAL RECORDS.

NOTE : THE ABOVE METES AND BOUNDS DESCRIPTION APPEARED PREVIOUSLY IN THAT CERTAIN DOCUMENT RECORDED APRIL 12, 2007, AS INSTRUMENT NO. 404249.

Subject to

THIS DEED IS GIVEN TO DIVEST ANY COMMUNITY PROPERTY INTEREST Jennifer Clark Kirby MAY HAVE IN THE ABOVE DESCRIBED REAL PROPERTY BY REASON OF HIS/HER MARRIAGE TO Daniel Villalobos.

TOGETHER with all tenements, hereditaments and appurtenances, including easements and water rights, if any, thereto belonging or appertaining, and any reversions, remainders, rents, issues or profits thereof.

Date: 06/06/2010

Jennifer Clark Kirby

UNOFFICIAL COPY



460527

06/16/2010
3 of 3

STATE OF **NEVADA**)
)
) :SS.
)
COUNTY OF **DOUGLAS**)

This instrument was acknowledged before me on

6/15/10 by
Jennifer Clark Kirby

Rishele L. Thompson

Notary Public

(My commission expires: 4/10/11)



UNOFFICIAL COPY

